

REV.	ECN. NO.	APPD.
A	WL-21-006	Jerry zhang

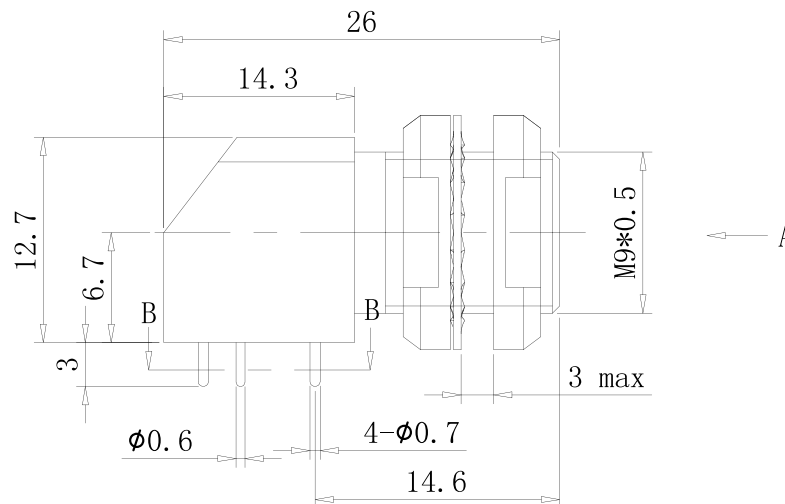
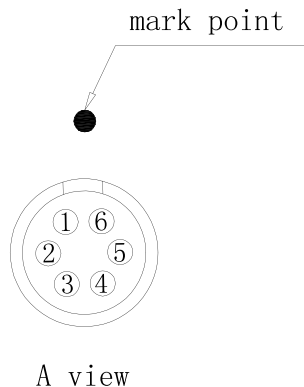

Product main performance:
 Operating Temperature: -55°C~125°C
 Humidity(max): <=95% [at 60 deg C / 140 F]
 Shielding: 75dB(10MHz) 40dB(1GHz)
 Salt Spray Corrosion: 96hr

Electrical data
 Vtest: 750V(contact-contact)
 working voltage: 300V AC,
 Insulation resistance: ≥5000M Ω
 Rated Current: 2.5A
 R (max): 10 mΩ

Mechanical data
 Vibration: 15g[10Hz~2000Hz]
 Shock Resistance: 100g[6ms]
 Endurance (Shell): 5000

Other Specification
 Contact Dia: 0.5mm
 Contact PIN: gold plated Phosphor bronze.
 Housing Material: chrome plated brass
 nut、screw: nickel plated brass
 Other metal spare parts : nickel plated brass
 Insulator material: PPSIP Rating: IP50

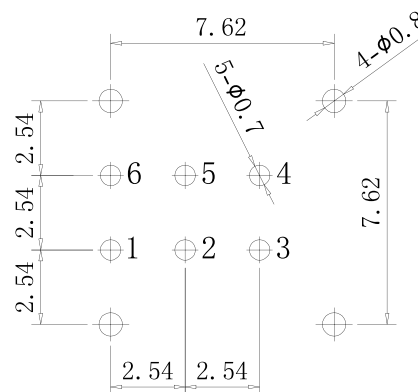

B-B
PCB cut-outs

*ALL MATERIALS ARE ROHS COMPLIANT
 IDEAS GENERATED DRAWING. DON'T CHANGE BY HAND.

x.±	x.±	UNITS mm	NAME(INTENDED USE) 0B 6-pin angled socket	CLASS: <input type="checkbox"/> CONFIDENTIAL <input type="checkbox"/> SECRET <input checked="" type="checkbox"/> GENERAL						
.x± 0.8	.x±	MAT'L	PART NO.(INTENDED USE) WLES13-7302							
.xx± 0.50	.xx±	SEE NOTES	APPD: Yuan. wu 03/14'21	TITLE: CONN DRAWING						
.xxx±	.xxx±	FINISH	CHKD: Lei. wang 03/15'21	DWG NO.: WLES13-7302-0114						
		Q'TY	DRAW: Min. sun 03/16'21	<table border="1"> <tr> <td>SCALE</td> <td>SHEET</td> <td>REV.</td> </tr> <tr> <td>N/A</td> <td>1/1</td> <td>A</td> </tr> </table>	SCALE	SHEET	REV.	N/A	1/1	A
SCALE	SHEET	REV.								
N/A	1/1	A								